



Type SPS Load Cell



Short Description



- Aluminium-alloy IP65 single point load cell
- Colorless anodized
- Suitable for pricing scales, bench scales, etc.
- Maximum platform size: 250 x 350 mm

 Test certificate no. TC7868 Revision 1
 C of C no R60/2000-NL1-12.52
 Certificate no. 11-012

Available Models

P/N	Capacity	Accuracy	Full Article Description
72202510	3kg	C3/C4/C5	SPS-C3/C4/C5-3kg-0.40B
72202511	5kg	C3/C4/C5	SPS-C3/C4/C5-5kg-0.40B
72202512	6kg	C3/C4/C5	SPS-C3/C4/C5-6kg-0.40B
72202513	7kg	C3/C4/C5	SPS-C3/C4/C5-7kg-0.40B
72202514	8kg	C3/C4/C5	SPS-C3/C4/C5-8kg-0.40B
72202515	10kg	C3/C4/C5	SPS-C3/C4/C5-10kg-0.40B
72202516	15kg	C3/C4/C5	SPS-C3/C4/C5-15kg-0.40B
72202517	20kg	C3/C4/C5	SPS-C3/C4/C5-20kg-0.40B
72202518	30kg	C3/C4/C5	SPS-C3/C4/C5-30kg-0.40B
72202519	35kg	C3/C4/C5	SPS-C3/C4/C5-35kg-0.40B
72202520	40kg	C3/C4/C5	SPS-C3/C4/C5-40kg-0.40B
72202521	50kg	C3/C4/C5	SPS-C3/C4/C5-50kg-0.40B
72202522	60kg	C3/C4/C5	SPS-C3/C4/C5-60kg-0.40B
72202523	100kg	C3/C4/C5	SPS-C3/C4/C5-100kg-0.40B
72202524	120kg	C3/C4/C5	SPS-C3/C4/C5-120kg-0.40B

Type SPS Load Cell

Technical Specifications SPS

Accuracy Class		OIML R60 C3	OIML R60 C4	OIML R60 C5
Output Sensitivity (= FS)	mV/V	2.0 ± 0.2		
Maximum Capacity (Emax)	kg	3, 5, 6, 7,8, 10, 15, 20, 30, 35, 40, 50,60,100,120		
Max. Number of Load Cell Intervals	nLc	3000	4000	5000
Ratio of min. LC Verification Interval	Y = Emax / vmin	10000	15000	20000
Combined Error	%FS	≤± 0.020	≤± 0.015	≤± 0.010
Creep Error (30 minutes)	%FS	≤± 0.0245	≤± 0.0184	≤± 0.0147
Temperature Effect on Zero (ZTC)	%FS/10°C	≤± 0.014	≤± 0.012	≤± 0.009
Temperature Effect on Sensitivity (STC)	%FS/10°C	≤± 0.0175	≤± 0.0131	≤± 0.0105
Zero Balance	%FS	≤± 2.0		
Safe Overload	%FS	120		
Ultimate Overload	%FS	150		
Maximum Deflection	mm	3kg:0.5~0.6	5-50kg:0.6~0.7	50-120kg:0.6~0.8
Eccentric Loading Error	%Ld/cm	± 0.002		
Excitation, Recommended Voltage	V	5 ~ 12		
Excitation, Maximum Voltage	V	18		
Input Resistance	Ω	406 ± 6		
Output Resistance	Ω	350 ± 3		
Insulation Resistance (50V)	MΩ	≥5000		
Compensated Temperature	°C	-10 ~ + 40		
Operating Temperature	°C	-35 ~ + 65		
Storage Temperature	°C	-40 ~ + 70		
Load Cell Weight	kg	~0.25		
Element Material		Aluminium		
Ingress Protection (acc. to EN 60529)		IP65		
Recommended Torque on Fixation Bolts	Nm	< 30kg: 6		>30kg: 10

Wiring

Features:

Cable type: Shielded, 4 conductor cable , conductor AWG 26
 Cable diameter: Ø 3.8mm
 Cable length: L = 0.40m ± 0.035m, L1 =0.05 ± 0.005m
 Cable jacket: PVC
 Shield not connected to element

Mode of Connection

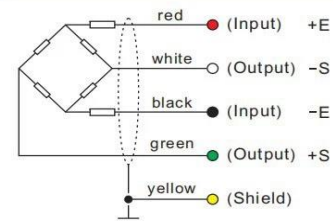



Type SPS Load Cell

Dimensions in mm

Top View

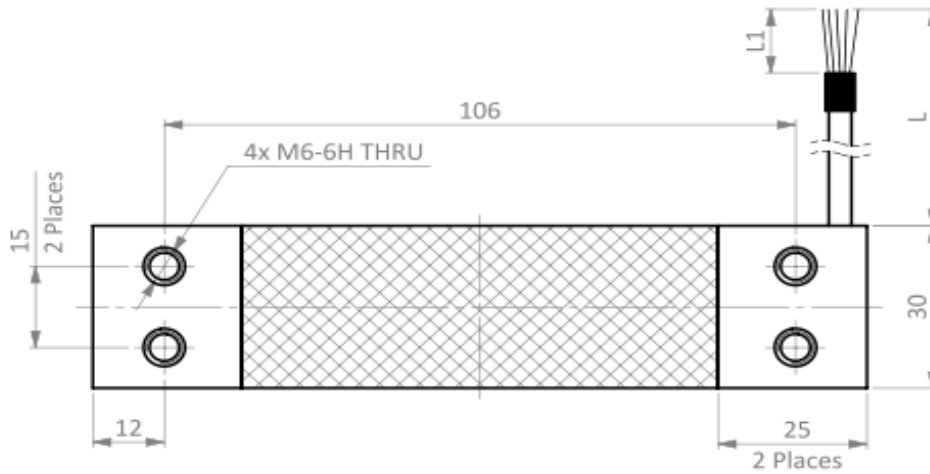

Note: Screws M6 class 8.8, screw rinsed with oil. Torque as in specifications table.

Front View

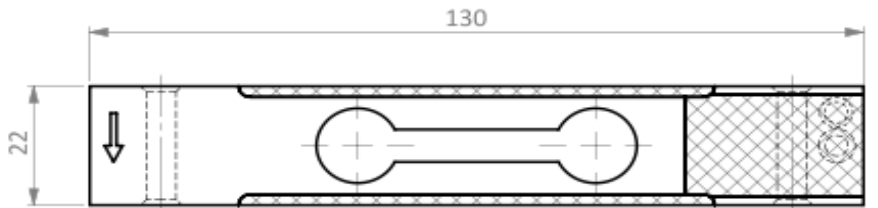

Side View

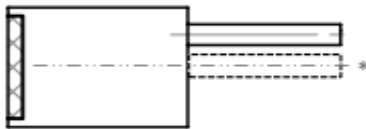

Isometric View

